

标记 MARK	更改内容 MODIFICATION	日期 DATE	修改 DRAW	核准 APPROVE

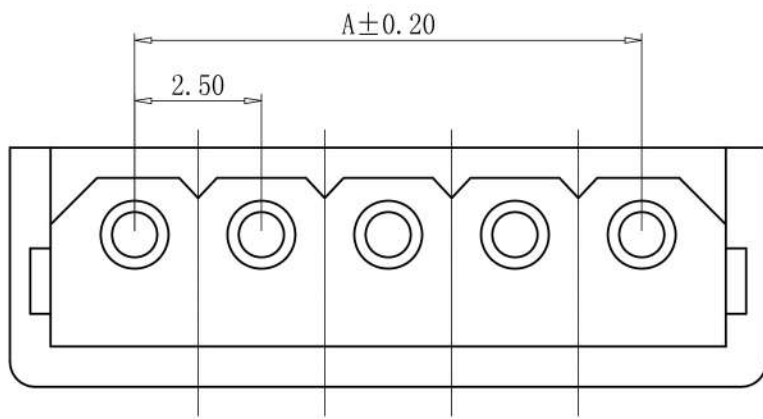
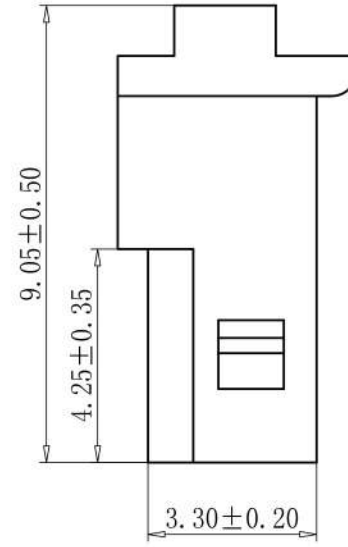
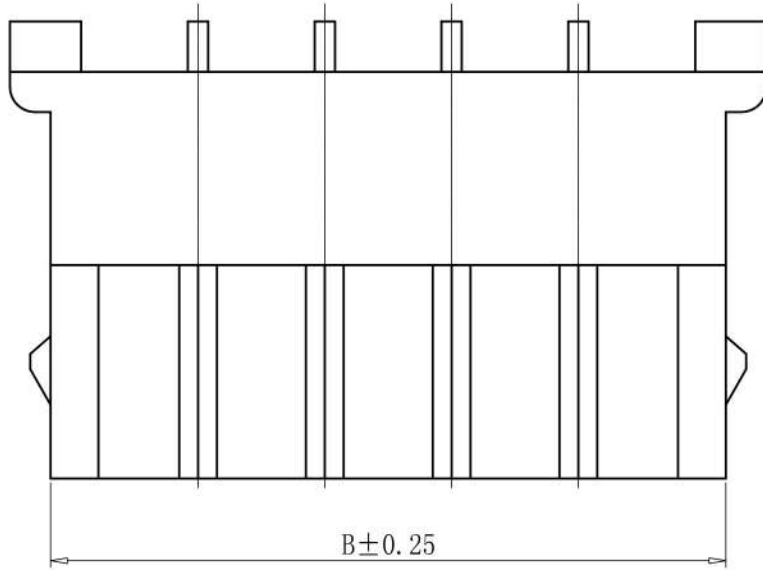

技术要求Specification:

- 1、材质Material: PA66 UL94V-0;
- 2、额定电流 Current rating:3.0A AC,DC
- 3、额定电压 Voltage rating: 250V AC,DC
- 4、温度范围 Temperature range:-25℃to+85℃
- 5、接触电阻 Contact resistance:  $\leq 20m\Omega$
- 6、绝缘电阻 Insulation resistance:  $\geq 1000M\Omega$
- 7、耐压 Withstand voltage:1000V AC/minute
- 8、塑件表面平整光洁, 无明显的毛刺、气泡、变形、浇口拉伤、缺料等不良现象。

Plastic surface smooth and clean, no obvious glitches, bubbles, distortion, gate strain, lack of material and other undesirable phenomena.

线数	型号	尺寸	
		A	B
2	SH25009-2Y	2.50	5.80
3	SH25009-3Y	5.00	8.30
4	SH25009-4Y	7.50	10.80
5	SH25009-5Y	10.00	13.30
6	SH25009-6Y	12.50	15.80
7	SH25009-7Y	15.00	18.30
8	SH25009-8Y	17.50	20.80
9	SH25009-9Y	20.00	23.30
10	SH25009-10Y	22.50	25.80
11	SH25009-11Y	25.00	28.30
12	SH25009-12Y	27.50	30.80
13	SH25009-13Y	30.00	33.30
14	SH25009-14Y	32.50	35.80
15	SH25009-15Y	35.00	38.30
16	SH25009-16Y	37.50	40.80

TOLERANCE UNLESS OTHERWISE SPECIFIED		*: Inspection Item		 <a href="http://www.canner.co.in">www.canner.co.in</a>	
.X±0.30	X.° ±1°	(NO.)	:Cp/Cpk and SPC Control Item		
.XX±0.20	.X° ±	材料	PA66	名称	5264-NY HOUSING
.XXX±0.10	.XX° ±	料厚		编号	SH25009-NY
		料宽		单位	MM
制图	丁浩然	料厚		比例	1:1
审核	林云昆	料宽		版本	A
批准	谭猛	日期	2024.08.07	角法	
		日期		规格书	

标记 MARK	更改内容 MODIFICATION	日期 DATE	修改 DRAW	核准 APPROVE

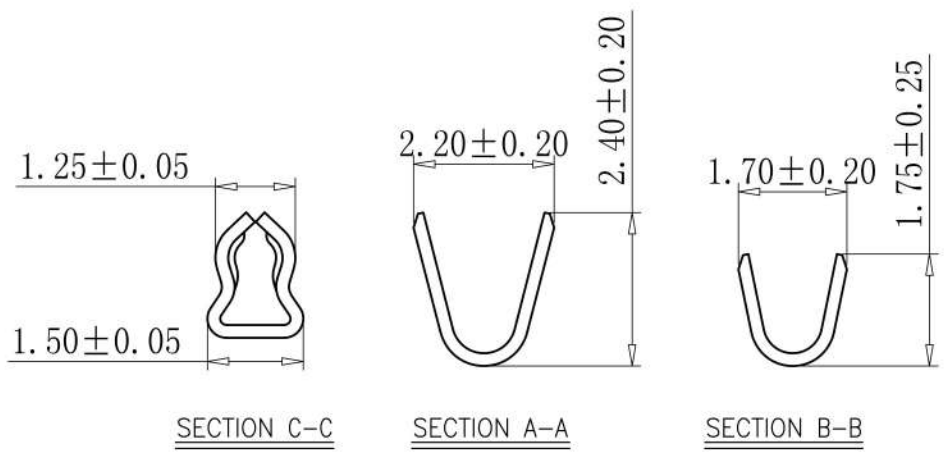
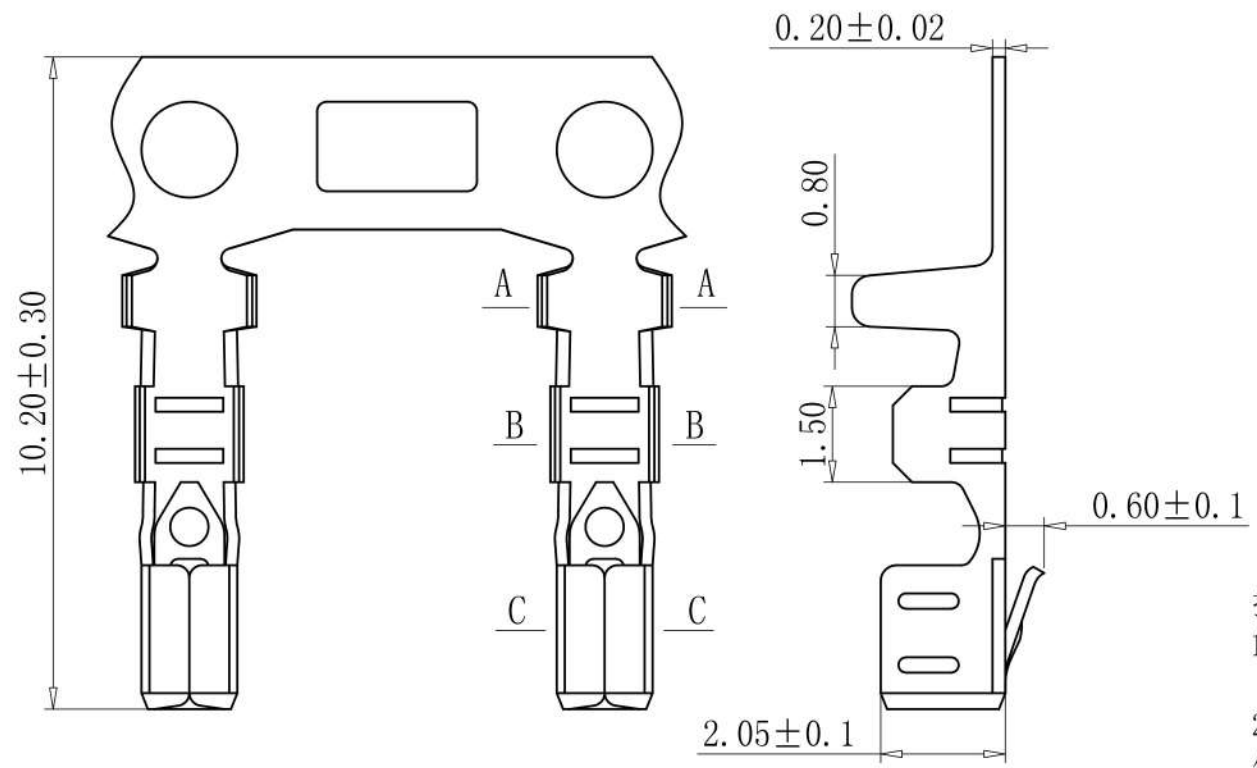

技术要求Specification:  
 1、材质：磷青铜,表面镀锡;  
**Material:Phos.Bronze Tin-Plated**  
 2、零件外观不得有有害毛刺、尖角、锐边和机械损伤;表面镀层应均匀、光亮、无雾斑、剥层等缺陷;  
**Parts may not have the appearance of harmful burrs,sharp corners,sharp edges and mechanical damage,surface coating should be uniform, bright,no fog spots,delamination and other defects.**  
 3、适用导线范围：Applicable wire:AWG # 28-# 22;

TOLERANCE UNLESS OTHERWISE SPECIFIED		*: Inspection Item		Canner® www.canner.co.in		
.X±0.30	X.° ±1"	NO.	:Cp/Cpk and SPC Control Item	名称 TITLE	5264-T TERMINAL	
.XX±0.20	.X° ±	材料 MATERIAL	磷青铜	料厚 THICK	0.20 mm	编号 DWG NO.
.XXX±0.10	.XX° ±	料宽 WIDE		比例 SCALE	1:1	单位 UNIT
制图 DRAWIN	赵旭强	料宽 WIDE		角法 PROJ.		版本 REV.
审核 CHECKED	江树钦	日期 DATE	2023.04.29			A
批准 APPROVE	谭猛					规格书

标记 MARK	更改内容 MODIFICATION	日期 DATE	修改 DRAW	核准 APPROVE

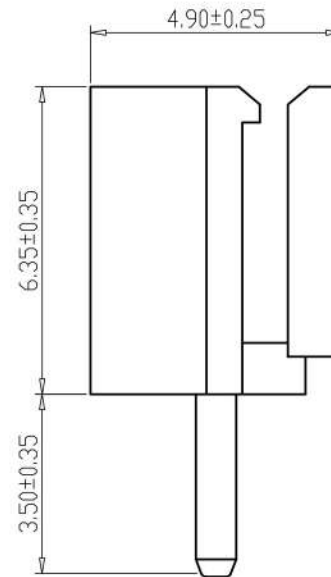
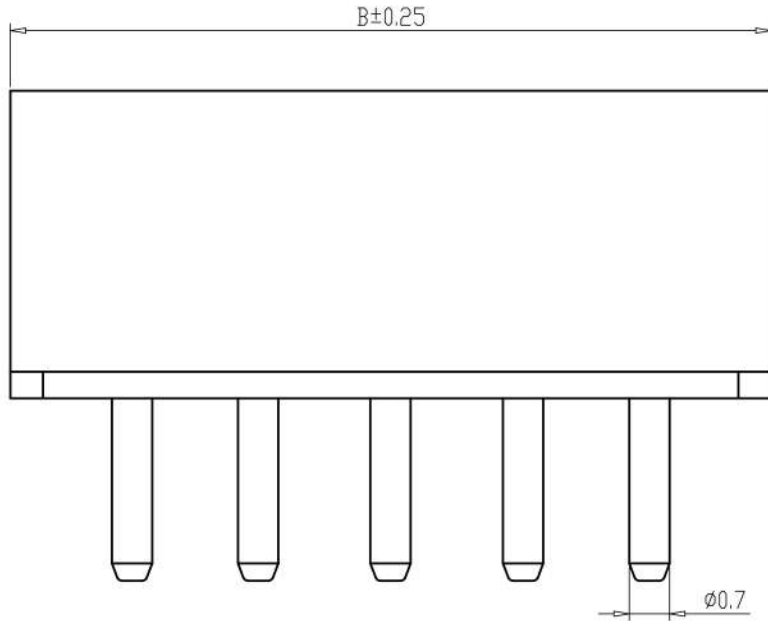
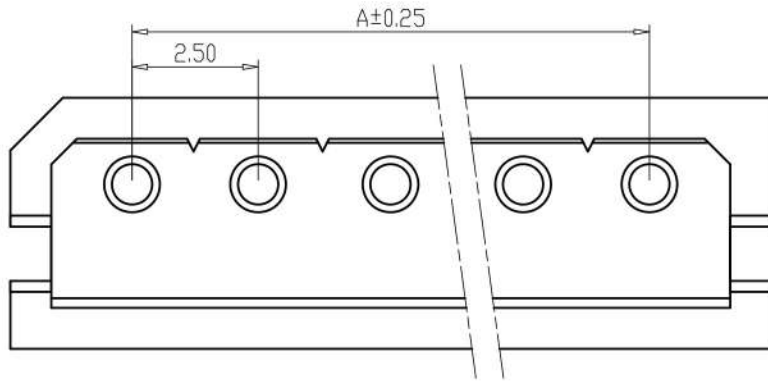

技术要求Specification:

- 1、材质Material: 塑座 Base:PA66 UL94V-2;  
针 Pin:黄铜 Brass Tin-Plated
- 2、塑件表面平整、光洁、无毛刺、气泡、变形、浇口无拉伤、缺料等不良现象。  
Housing Surface Levelling、Clen and tidy、No burr、Air bubble、Deformation、  
No pull、Lackmaterial Unhealthy tendencies.

线数	型号	尺寸	
		A	B
2	SH25009-2A	2.50	7.50
3	SH25009-3A	5.00	10.00
4	SH25009-4A	7.50	12.50
5	SH25009-5A	10.00	15.00
6	SH25009-6A	12.50	17.50
7	SH25009-7A	15.00	20.00
8	SH25009-8A	17.50	22.50
9	SH25009-9A	20.00	25.00
10	SH25009-10A	22.50	27.50
11	SH25009-11A	25.00	30.00
12	SH25009-12A	27.50	32.50
13	SH25009-13A	30.00	35.00
14	SH25009-14A	32.50	37.50
15	SH25009-15A	35.00	40.00
16	SH25009-16A	37.50	42.50

TOLERANCE UNLESS OTHERWISE SPECIFIED		*: Inspection Item		Canner® www.canner.co.in			
.X±0.30	X.° ±1"	NO.	:Cp/Cpk and SPC Control Item	名称	5264-NA		
.XX±0.20	.X° ±			材料	PA66	编号	SH25009-NA
.XXX±0.10	.XX° ±			料厚		单位	MM
制图	丁浩然	料宽		比例	1:1	版本	A
审核	林云昆	日期	2024.08.07	角法		规格书	
批准	谭猛	日期	2024.08.07	角法		规格书	

标记 MARK	更改内容 MODIFICATION	日期 DATE	修改 DRAW	核准 APPROVE

技术要求Specification:

- 1、材质Material: 塑座 Base:PA66 UL94V-2;  
针 Pin:黄铜 Brass Tin-Plated
- 2、塑件表面平整、光洁、无毛刺、气泡、变形、浇口无拉伤、缺料等不良现象。  
Housing Surface Levelling, Clen and tidy, No burr, Air bubble, Deformation, No pull, Lackmaterial Unhealthy tendencies.

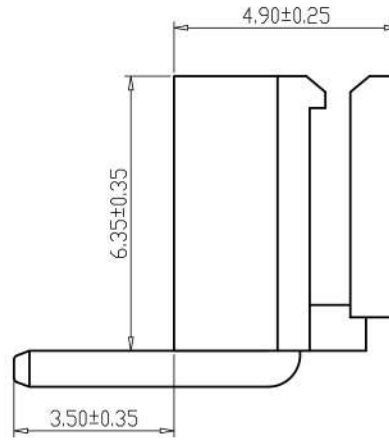
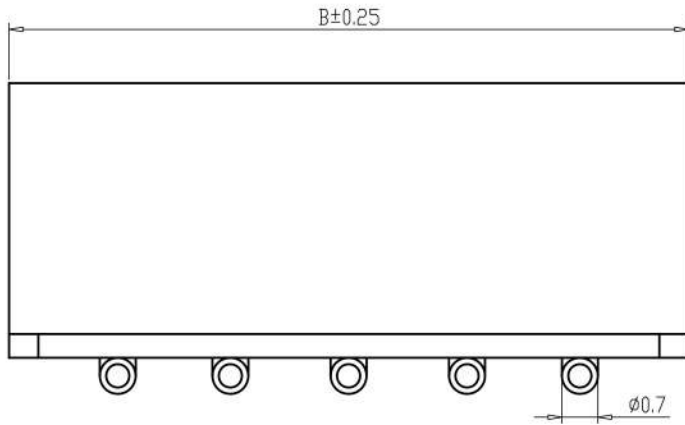
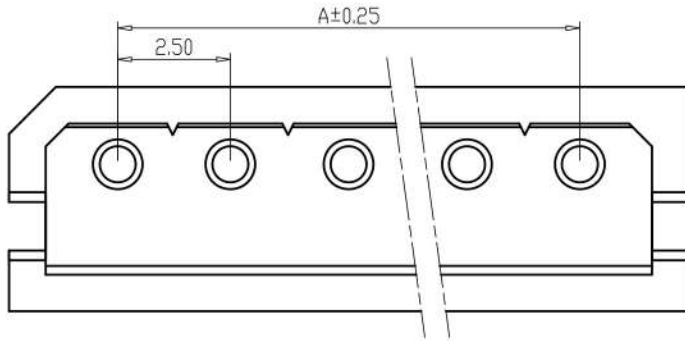

线数	型号	尺寸	
		A	B
2	SH25009-2AW	2.50	7.50
3	SH25009-3AW	5.00	10.00
4	SH25009-4AW	7.50	12.50
5	SH25009-5AW	10.00	15.00
6	SH25009-6AW	12.50	17.50
7	SH25009-7AW	15.00	20.00
8	SH25009-8AW	17.50	22.50
9	SH25009-9AW	20.00	25.00
10	SH25009-10AW	22.50	27.50
11	SH25009-11AW	25.00	30.00
12	SH25009-12AW	27.50	32.50
13	SH25009-13AW	30.00	35.00
14	SH25009-14AW	32.50	37.50
15	SH25009-15AW	35.00	40.00
16	SH25009-16AW	37.50	42.50

TOLERANCE UNLESS OTHERWISE SPECIFIED		*: Inspection Item		Canner® www.canner.co.in			
.X±0.30	X.° ±1"	NO.	:Cp/Cpk and SPC Control Item	名称	5264-NAW		
.XX±0.20	.X° ±			材料	PA66	标题	SH25009-NAW
.XXX±0.10	.XX° ±			料厚		DWG NO.	单位
制图	丁浩然	料宽		比例	1:1	版本	M M
审核	林云昆	日期	2024.08.07	角法	⊕	规格书	A
批准	谭猛	日期	2024.08.07	角法	⊕	规格书	A